



# TWD

## 150mm SQUARE TOP FLOOR DRAIN

### TWD150SQFD

Push-in series commercial floor drain for indoor and outdoor applications

Suitable for floor finishes from concrete tiled and resin.

#### Product Codes:

**TWD150SQFD**

#### Specification:

Application:	Commercial Drainage
Floor:	Concrete / Tiled / Resin
Frame (mm):	150 x 150
Outlet Diameter (mm):	97
Material:	SS304
Load Class AS3996 (kg):	L15
Standards / Specification:	• WMTS-040 • AS3996 • AS4586
Secure Lock Grating:	Anti - Vandal Screw
Outlet Direction:	Vertical
Shape:	Square
Dimensions (mm):	See Drawing
Weight (kg):	2.25
Ring Seal:	EPDM

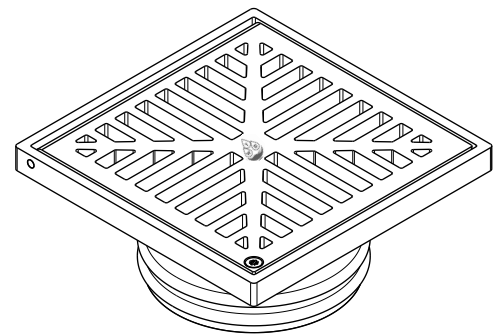
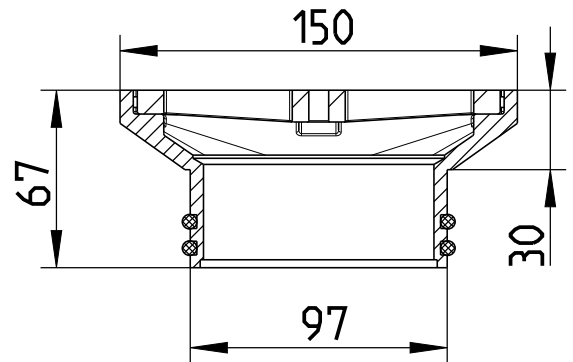

#### Features:

- Non-Slip.
- Secure Lock Grating.
- 110° Hinged Grating.
- Heel Safe Grating.
- Suitable for use with stainless steel, cast iron, copper, HDPE, PVC and PP pipe and fittings.